

RONY ADJUST petit

INSTALLATION INSTRUCTIONS | NOVEMBER 2024

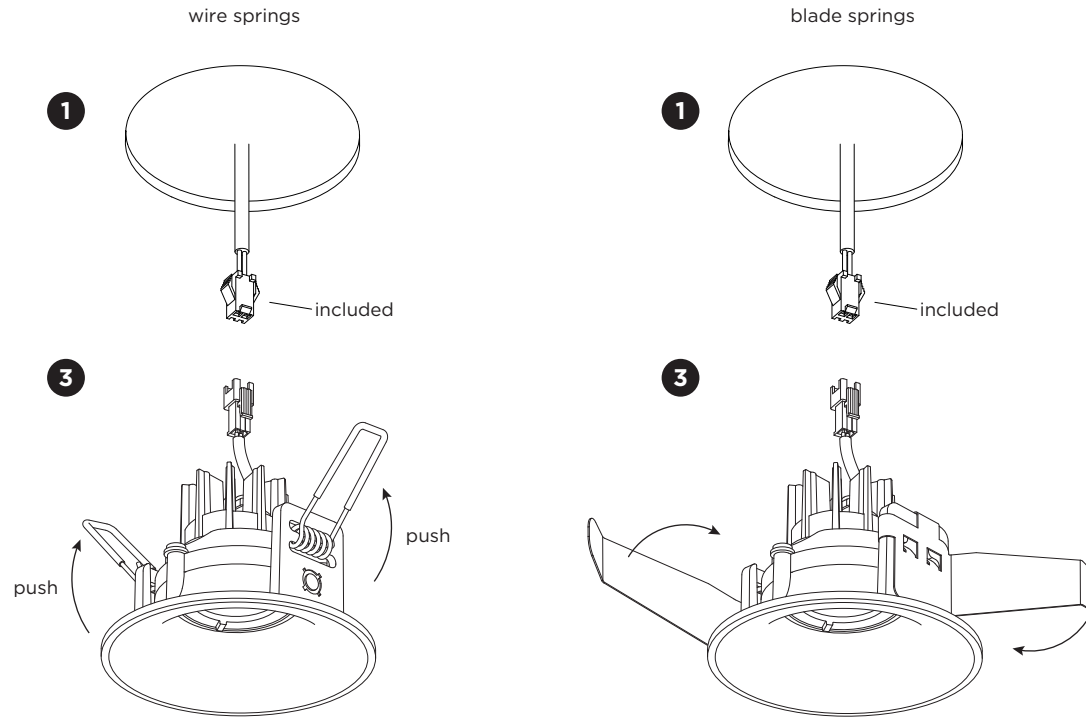

Driver must be powered off before connecting the cables.

Before connecting the luminaire/LED module to the driver please make sure the driver is not powered but disconnected from the mains. The driver can only be powered when the luminaire/LED module is already connected. Disregarding this instruction might damage or even destroy the luminaire/LED module.

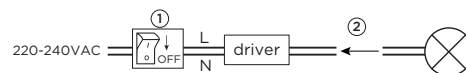

DIMENSIONS

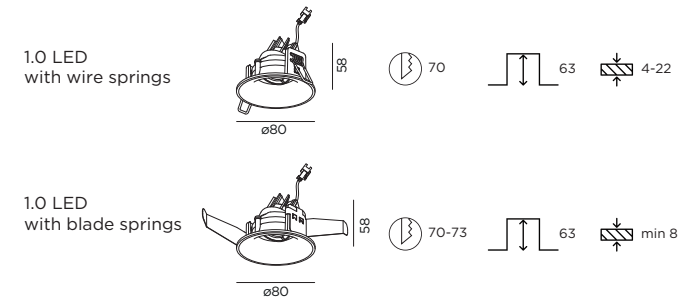

MOUNTING INSTRUCTION

1 Make a hole in the ceiling according to the prescribed dimensions.

2 POWER CONNECTION

Always use a driver according to the specifications of the LED module.

Single connection



Multiple connection

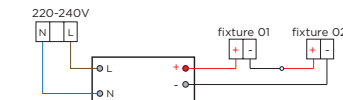

3 For wire springs:

Push the springs upwards and insert the fixture in the ceiling hole.

For blade springs:

Push the springs towards the fixture when inserting the fixture in the ceiling hole.

WEVER & DUCRÉ BV

Spinnerijstraat 99/21, 8500 Kortrijk, Belgium
weverducre.com

RONY ADJUST petit

INSTALLATION INSTRUCTIONS | NOVEMBER 2024

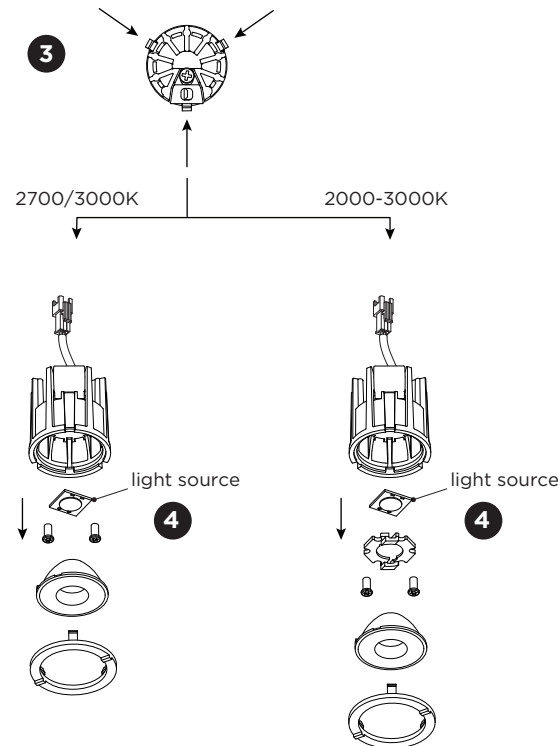
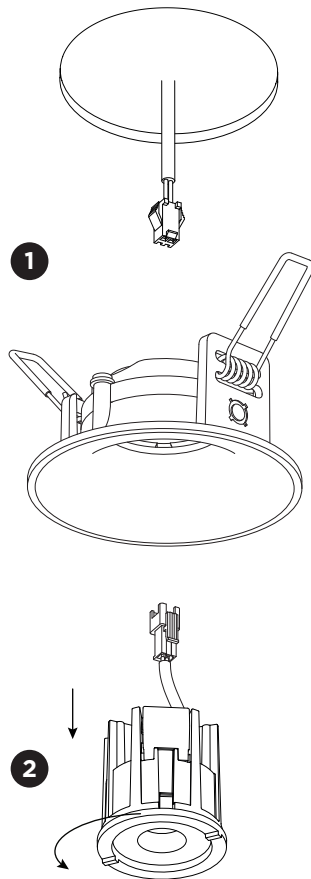

DISMOUNTING AND RECYCLING INSTRUCTIONS

Light source

- 1 Take the luminaire out of the ceiling hole and disconnect the plugs.
- 2 Hold and turn the front ring a quarter counter clockwise to remove the LED module.
- 3 Push at the three points to loosen the front ring.
- 4 Take the lens out and unscrew the holder or light source to remove the light source.

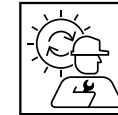

The light source is replaceable by Wever & Ducré or by a professional with explicit authorisation. For more information please contact your local Wever & Ducré customer service point.



This luminaire contains a light source with the energy class D.



WEVER & DUCRÉ
LIGHTING

WEVER & DUCRÉ BV

Spinnerijstraat 99/21, 8500 Kortrijk, Belgium
weverducre.com