

## Standard Ballasts 14–65 W, 230 V

For fluorescent lamps  
Shape: 28x41 mm

Vacuum-impregnated with polyester resin  
Push-in terminal for leads: 0.5–1 mm<sup>2</sup>  
For the automatic luminaire wiring:  
IDC terminals for leads H05V-U 0.5  
tw 130  
Protection class I

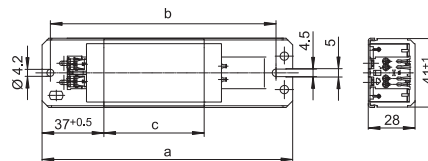
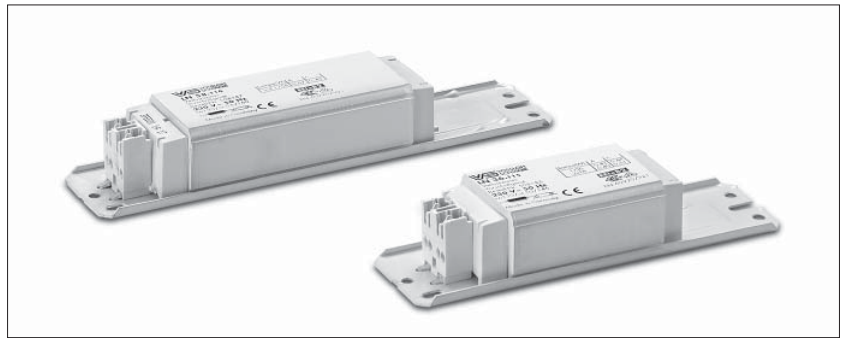

Lamp				Ballast										Capacitor	
Output	Type	Base	Current	Type	Ref. No.	Voltage	a	b	c	Weight	Δt/ΔI <sub>an.</sub>	Energy efficiency	C <sub>p</sub>	Current	
W			mA			V, Hz	mm	mm	mm	kg	K		μF	mA	
<b>230 V, 50 Hz</b>															
14	T8 (T26)	G13	395	LN 18.510*	<b>164572</b>	230, 50	155	140	92	0.80	40/65	B2	4.5	150	
15	T8 (T26)	G13	310	LN 15.329*	<b>163861</b>	230, 50	150	140	60	0.55	50/80	B2	3.5	120	
2x15	T8 (T26)	G13	340	INN 30.045	<b>564191</b>	230, 50	232.5	220	160	1.35	25/40	<b>A2</b>	4.0	185	
				LN 30.801*	<b>169645</b>	230, 50	150	140	60	0.55	55/110	B2	4.0	185	
				L 30.347*	<b>164033</b>	230, 50	150	140	60	0.55	60/150	—	4.0	185	
16	T8 (T26)	G13	200	LN 16.316*	<b>163730</b>	230, 50	85	75	34	0.32	60/125	B1	2.0	90	
18/20	T8 (T26)/T12 (T38)	G13	370	LN 18.510*	<b>164572</b>	230, 50	155	140	92	0.80	40/65	B1	4.5	120	
				LN 18.131*	<b>530941</b>	230, 50	150	140	60	0.55	55/95	B2	4.5	120	
				L 18.934*	<b>534621</b>	230, 50	150	140	45	0.43	70/150	—	4.5	120	
2x18/20	T8 (T26)/T12 (T38)	G13	400	INN 2x18.043	<b>564189</b>	230, 50	150	135	60	0.55	40/160	<b>A2</b>	4.0	210	
				LN 2x18.135*	<b>532155</b>	230, 50	150	140	45	0.43	65	B1	4.0	210	
25	T12 (T38)	G13	290	L 25.346*	<b>164013</b>	230, 50	150	140	60	0.55	45/80	B1	3.5	130	
30	T8 (T26)	G13	365	INN 30.045	<b>564191</b>	230, 50	232.5	220	160	1.35	25/40	<b>A2</b>	4.5	180	
				LN 30.801*	<b>169645</b>	230, 50	150	140	60	0.55	55/110	B2	4.5	180	
36-1	T8 (T26)	G13	556	L 36.342*	<b>538072</b>	230, 50	195	180	110	0.87	50/120	B2	6.5	250	
36/40	T8 (T26)/T12 (T38)	G13	430	LN 36.570*	<b>169779</b>	230, 50	155	140	92	0.80	35/90	B1	4.5	210	
				LN 36.511*	<b>164590</b>	230, 50	155	140	92	0.80	35/95	B1	4.5	210	
				LN 36.130*	<b>527191</b>	230, 50	150	140	60	0.55	50/140	B2	4.5	210	
				LN 36.149*	<b>529029</b>	230, 50	150	140	60	0.55	55/150	B2	4.5	210	
38	T8 (T26)	G13	430	L 36.132*	<b>535977</b>	230, 50	150	140	45	0.43	65	—	4.5	210	
				LN 36.570*	<b>169779</b>	230, 50	155	140	92	0.80	35/90	B1	4.5	210	
				LN 36.511*	<b>164590</b>	230, 50	155	140	92	0.80	35/95	B1	4.5	210	
				LN 36.149*	<b>529029</b>	230, 50	150	140	60	0.55	55/150	B2	4.5	210	
58/65	T8 (T26)/T12 (T38)	G13	670	L 36.132*	<b>535977</b>	230, 50	150	140	45	0.43	65	—	4.5	210	
				LN 58.568*	<b>169389</b>	230, 50	233	220	160	1.31	35/95	B1	7.0	320	
				LN 58.990*	<b>509349</b>	230, 50	190	180	110	0.95	50/130	B2	7.0	320	
				LN 58.116*	<b>508186</b>	230, 50	190	180	92	0.80	55/160	B2	7.0	320	
				L 58.718*	<b>169658</b>	230, 50	190	180	92	0.80	60/170	—	7.0	320	

\* Ballasts without CE marking for replacements or markets outside of the EU