



kop verlichte drukknop - Ø 22 - rood - voor invoegen van etiket

ZB5AA4

Hoofdkenmerken

| | |
|------------------------------------|----------------------------------|
| productgamma | Harmony XB5 |
| type product of component | Kop voor niet-verlichte drukknop |
| korte naam apparaat | ZB5 |
| materiaal kraag | Donkergrijs kunststof |
| bevestigingsdiameter | 22 mm |
| koptype | Standard |
| verkoop per ondeelbare hoeveelheid | 1 |
| vorm van kop signaleringseenheid | Rond |
| type operator | terugverend |
| profiel operator | Rood verzonken, niet gemarkeerd |

Complementaire kenmerken

| | |
|--------------------------------|-----------------------------------------------------------------------------------------------------------------------------------------------------------------------------------------------------------------------------------------------------------------------------------------------------------------------------------------------------------------------------------------------------------------------------------------------------|
| CAD totale breedte | 29 mm |
| CAD totale hoogte | 29 mm |
| CAD totale diepte | 28 mm |
| gewicht product | 0,018 kg |
| mechanische levensduur | 10000000 cycli |
| naam station | XALD 1...5 uitsnijdingen XALK 2...5 uitsnijdingen |
| elektrische samenstellingscode | C1 voor <9 contacten met enkelvoudig blokken in vooraan gemonteerd C2 voor <9 contacten met enkelvoudig en dubbel blokken in vooraan gemonteerd C11 voor <3 contacten met enkelvoudig blokken in vooraan gemonteerd C15 voor <1 contacten met enkelvoudig blokken in vooraan gemonteerd SF1 voor <3 contacten met enkelvoudig blokken in vooraan gemonteerd SR1 voor <3 contacten met enkelvoudig blokken in montage aan achterzijde |
| presentatie product | Basiselement |

Omgeving

| | |
|----------------------------------|-------------------------------------------------|
| beschermende behandeling | TH |
| omgevingstemperatuur bij opslag | -40...70 °C |
| omgevingstemperatuur bij werking | -40...70 °C |
| overspanningscategorie | Klasse II conforming to IEC 60536 |
| IP-beschermingsgraad | IP66 conform IEC 60529 IP67 IP69 IP69K |

Disclaimer: Deze documentatie is niet bedoeld als vervanging voor en mag niet worden gebruikt voor het bepalen van de geschiktheid of betrouwbaarheid van deze producten voor specifieke gebruikerstoepassingen

| | |
|------------------------------|--------------------------------------------------------------------------------------------------------------------------------------------------------------|
| NEMA beschermingsgraad | NEMA 13 NEMA 4X |
| weerstand hoge druk drukring | 7000000 Pa bij 55 °C, afstand : 0.1 m |
| IK-beschermingsgraad | IK03 conforming to IEC 50102 |
| normen | IEC 60947-1 CSA C22.2 Nr 14 IEC 60947-5-1 JIS C8201-5-1 IEC 60947-5-4 UL 508 JIS C8201-1 |
| productcertificeringen | DNV CSA BV LROS (Lloyds register of shipping) UL listed |
| schokbestendigheid | 30 gn (duur = 18 ms) voor halve sinusgolf versnelling conform IEC 60068-2-27 50 gn (duur = 11 ms) voor halve sinusgolf versnelling conform IEC 60068-2-27 |
| trillingsweerstand | 5 gn (f= 2...500 Hz) conforming to IEC 60068-2-6 |

Verpakkingseenheden

| | |
|------------------------------|-----------|
| Unit Type of Package 1 | PCE |
| Number of Units in Package 1 | 1 |
| Package 1 Height | 4,400 cm |
| Package 1 Width | 3,400 cm |
| Package 1 Length | 5,400 cm |
| Package 1 Weight | 17,000 g |
| Unit Type of Package 2 | S03 |
| Number of Units in Package 2 | 300 |
| Package 2 Height | 30,000 cm |
| Package 2 Width | 30,000 cm |
| Package 2 Length | 40,000 cm |
| Package 2 Weight | 5,563 kg |
| Unit Type of Package 3 | P06 |
| Number of Units in Package 3 | 2400 |
| Package 3 Height | 75,000 cm |
| Package 3 Width | 60,000 cm |
| Package 3 Length | 80,000 cm |
| Package 3 Weight | 54,524 kg |

Contractuële waarborg

| | |
|----------|-----------|
| Garantie | 18 months |
|----------|-----------|

Schneider Electric wil tegen 2050 de Net Zero-status hebben bereikt via partnerschappen in de toeleveringsketen, materialen met een lagere impact en circulariteit via onze doorlopende campagne "Use Better, Use Longer, Use Again" om de levensduur van producten en de recycleerbaarheid te verlengen.

[Uitleg van Environmental Data](#) >

[Hoe evalueren we de duurzaamheid van producten?](#) >

| Milieuvoetafdruk | |
|---------------------------------|-----------------------------------------------|
| Koolstofvoetafdruk (kg CO2 eq.) | 1 |
| Milieurapportage | Milieuprofiel van het product |

Use Better

| Materialen en verpakking | |
|-----------------------------------|--------------------------------------------------------------------------------|
| Pakket met gerecycleerd karton | Ja |
| Verpakkingen zonder kunststof | Ja |
| RoHS-richtlijn EU | Pro-actieve naleving (product valt buiten juridisch toepassingsgebied RoHS EU) |
| REACH-regeling | REACH-verklaring |
| RoHS-verordening China | RoHS-verklaring China |

Use Again

| Herverpakken en herfabriceren | |
|-------------------------------|--------------------------------------------------|
| Circulariteitsprofiel | Informatie over einde levensduur |
| Terugname | No |

Dimensions Drawings

Dimensions

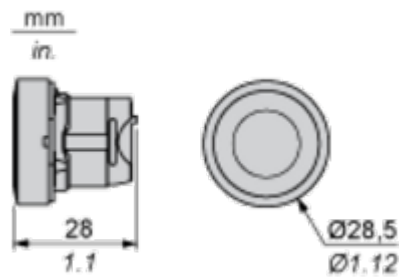

Mounting and Clearance

Panel Cut-out for Pushbuttons, Switches and Pilot Lights (Finished Holes, Ready for Installation)

Connection by Screw Clamp Terminals or Plug-in Connectors or on Printed Circuit Board

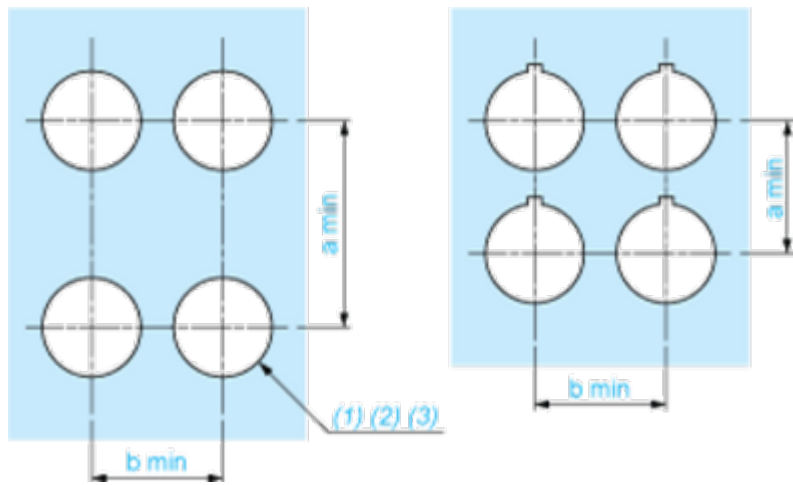

- (1) Diameter on finished panel or support
(2) For selector switches and Emergency stop buttons, use of an anti-rotation plate type ZB5AZ902 is recommended.
(3) Ø22.5 mm recommended ($\text{Ø}22.3 \begin{smallmatrix} +0.4 \\ 0 \end{smallmatrix}$) / Ø0.89 in. recommended ($\text{Ø}0.88 \text{ in. } \begin{smallmatrix} +0.016 \\ 0 \end{smallmatrix}$)

| Connections | a in mm | a in in. | b in mm | b in in. |
|-----------------------------------------------|---------|----------|---------|----------|
| By screw clamp terminals or plug-in connector | 40 | 1.57 | 30 | 1.18 |
| By Faston connectors | 45 | 1.77 | 32 | 1.26 |
| On printed circuit board | 30 | 1.18 | 30 | 1.18 |

Detail of Lug Recess

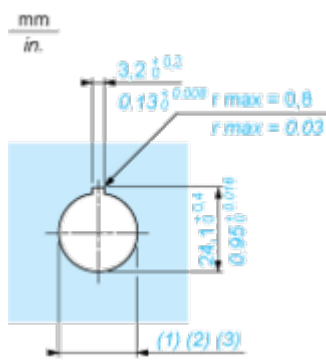

- (1) Diameter on finished panel or support
(2) For selector switches and Emergency stop buttons, use of an anti-rotation plate type ZB5AZ902 is recommended.
(3) Ø22.5 mm recommended ($\text{Ø}22.3 \begin{smallmatrix} +0.4 \\ 0 \end{smallmatrix}$) / Ø0.89 in. recommended ($\text{Ø}0.88 \text{ in. } \begin{smallmatrix} +0.016 \\ 0 \end{smallmatrix}$)

Pushbuttons, Switches and Pilot Lights for Printed Circuit Board Connection

Panel Cut-outs (Viewed from Installer’s Side)



A: 30 mm min. / 1.18 in. min.
B: 40 mm min. / 1.57 in. min.

Printed Circuit Board Cut-outs (Viewed from Electrical Block Side)

Dimensions in mm



A: 30 mm min.
B: 40 mm min.
Dimensions in in.



A: 1.18 in. min.
B: 1.57 in. min.

General Tolerances of the Panel and Printed Circuit Board

The cumulative tolerance must not exceed 0.3 mm / 0.012 in.: T1 + T2 = 0.3 mm max.

Installation Precautions

- Minimum thickness of circuit board: 1.6 mm / 0.06 in.
- Cut-out diameter: 22.4 mm ± 0.1 / 0.88 in. ± 0.004
- Orientation of body/fixing collar ZB5AZ009: $\pm 2^\circ 30'$ (excluding cut-outs marked a and b).
- Tightening torque of screws ZBZ006: 0.6 N.m (5.3 lbf.in) max.
- Allow for one ZB5AZ079 fixing collar/pillar and its fixing screws:
 - every 90 mm / 3.54 in. horizontally (X), and 120 mm / 4.72 in. vertically (Y).
 - with each selector switch head (ZB5AD•, ZB5AJ•, ZB5AG•).

The fixing centers marked a and b are diagonally opposed and must align with those marked 4 and 5.



- (1) Head ZB5AD•
- (2) Panel
- (2) Nut
- (4) Printed circuit board

Mounting of Adapter (Socket) ZBZ01•

- 1 2 elongated holes for ZBZ006 screw access
- 2 1 hole Ø 2.4 mm ± 0.05 / 0.09 in. ± 0.002 for centring adapter ZBZ01•
- 3 8 × Ø 1.2 mm / 0.05 in. holes
- 4 1 hole Ø 2.9 mm ± 0.05 / 0.11 in. ± 0.002, for aligning the printed circuit board (with cut-out marked a)
- 5 1 elongated hole for aligning the printed circuit board (with cut-out marked b)
- 6 4 holes Ø 2.4 mm / 0.09 in. for clipping in adapter ZBZ01•

Dimensions An + 18.1 relate to the Ø 2.4 mm ± 0.05 / 0.09 in. ± 0.002 holes for centring adapter ZBZ01•.

Technical Description

Electrical Composition Corresponding to Code C1



Electrical Composition Corresponding to Code C2



Electrical Composition Corresponding to Codes C9, C11, SF1 and SR1



Electrical Composition Corresponding to Code C15

1 N/O

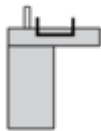

1 N/C



1 N/O + N/C or 1 N/O + N/O or 1 N/C + N/C

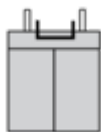

Legend

Single contact



Double contact



Light block



Possible location



Technical Illustration

Dimensions

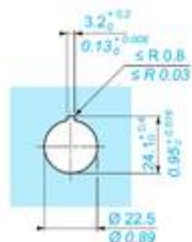
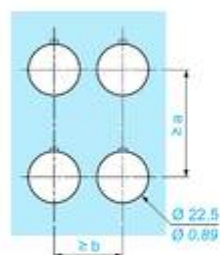
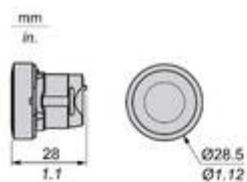

| | | a (mm) | a (in.) | b (mm) | b (in.) |
|------------------------------------------------------------------------------------|------------------------------------------------------------------------------------|--------|---------|--------|---------|
|  |  | 40 | 1.57 | 30 | 1.18 |
| ZBE..... | ZBV..... | | | | |
|  |  | 45 | 1.77 | 32 | 1.26 |
| ZBE.....3 | ZBV.....3 | | | | |
|  |  | 40 | 1.57 | 30 | 1.18 |
| ZBE.....4 | ZBV.....4 | | | | |
|  |  | 50 | 1.97 | 30 | 1.18 |
| ZBE.....5 | ZBV.....5 | | | | |
|  |  | 40 | 1.57 | 30 | 1.18 |
| ZBE.....9 | ZBV.....9 | | | | |
|  |  | 40 | 1.57 | 30 | 1.18 |
| ZBRV1 | ZBRV1 | | | | |

Offer Marketing Illustration

Product benefits / Features



Offer Marketing Illustration

Product benefits / Features

Features

Harmony XB5



Quick and easy assembly and disassembly



Excellent mechanical connection with operator head



Various types of connection: screw clamp, connector, Faston connector, spring terminal, or printed circuit board



Robustness to withstand harsh environments



Large set of accessories to customize your panels



Image of product / Alternate images

Alternative

