

Productinformatieblad

Specificaties



Ø 60 mm verlichte LED eenheid - knipperend - wit - IP65 - 24 V AC/DC

XVUC47

Hoofdkenmerken

productgamma	Harmony XVU
type product of component	Modulaire signaalkolom
type element signaalkolom	Ledeenhed
bevestigingsdiameter	60 mm
naam component	XVU
lichtbron	LED, wit
apparaattoepassing	Machinewerktuigen Zelfaandrijvend Verpakkingsmachine

Complementaire kenmerken

type signalering	Knipperend
constructie-variante	Tot 4 eenheden met zoemer Klantassemblage, tot 5 eenheden
materiaal	PC (polycarbonaat) V-2 vlamvertrager conform UL 94 PC (polycarbonaat) V-0 vlamvertrager conform UL 94
[Us] nominale voedingsspanning	24 V AC/DC
Maximaal vermogensverlies in W	1,2 W
Referentie maateenheid	Knipperend
lengte	50 mm
gewicht product	0,064 kg

Omgeving

productcertificeringen	CSA CE UL
omgevingstemperatuur bij opslag	-40...70 °C
IP-beschermingsgraad	IP65
omgevingstemperatuur bij werking	-25...50 °C
trillingsweerstand	2 gn

Verpakkingseenheden

Unit Type of Package 1	PCE
Number of Units in Package 1	1
Package 1 Height	9,0 cm

Disclaimer: Deze documentatie is niet bedoeld als vervanging voor en mag niet worden gebruikt voor het bepalen van de geschiktheid of betrouwbaarheid van deze producten voor specifieke gebruikerstoepassingen

Package 1 Width	9,1 cm
Package 1 Length	13,3 cm
Package 1 Weight	143,0 g
Unit Type of Package 2	S03
Number of Units in Package 2	24
Package 2 Height	30 cm
Package 2 Width	30 cm
Package 2 Length	40 cm
Package 2 Weight	4,057 kg
Unit Type of Package 3	P06
Number of Units in Package 3	192
Package 3 Height	75 cm
Package 3 Width	40 cm
Package 3 Length	80 cm
Package 3 Weight	52,456 kg



Contractuële waarborg

Garantie	18 maanden
----------	------------

Schneider Electric wil tegen 2050 de Net Zero-status hebben bereikt via partnerschappen in de toeleveringsketen, materialen met een lagere impact en circulariteit via onze doorlopende campagne "Use Better, Use Longer, Use Again" om de levensduur van producten en de recycleerbaarheid te verlengen.

[Uitleg van Environmental Data](#) >

[Hoe evalueren we de duurzaamheid van producten?](#) >

<div>Milieuvoetafdruk</div>	
Milieurapportage	Milieuprofiel van het product
Use Better	
<div>Materialen en verpakking</div>	
Pakket met gerecycleerd karton	Nee
Verpakkingen zonder kunststof	Nee
RoHS-richtlijn EU	Pro-actieve naleving (product valt buiten juridisch toepassingsgebied RoHS EU)
SCIP-nummer	C06fce4f-aea2-46a5-aadb-0b38d1efbe3f
REACH-regeling	REACH-verklaring
RoHS-verordening China	RoHS-verklaring China
Use Again	
<div>Herverpakken en herfabriceren</div>	
Circulariteitsprofiel	Informatie over einde levensduur
Terugname	No

Dimensions Drawings

Illuminated LED Unit

Dimensions

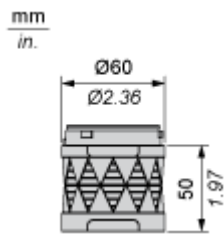

Mounting and Clearance

Modular Tower Lights Mounting

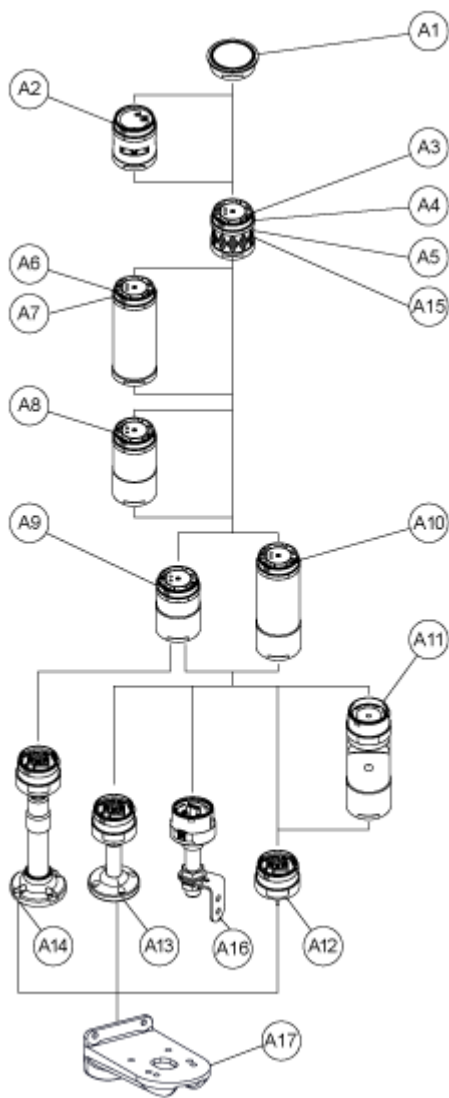

Drawing	Part number	Part name
A1	-	Top cover
	-	Top cover (Silver)
A2	XVUC9S	Buzzer unit
	XVUC9SQ	Buzzer unit (Silver)
A3	XVUC23	Green LED unit
	XVUC24	Red LED unit
	XVUC25	Orange LED unit
	XVUC26	Blue LED unit

Drawing	Part number	Part name
	XVUC27	White LED unit
	XVUC28	Yellow LED unit
A4	XVUC29	Multi-LED unit
A5	XVUC29P	Multi-LED unit, Pulse signal
A6	XVUC9V	Sound unit
A7	XVUC9VP	Sound unit, Pulse signal
A8	XVUC020	Extender
	XVUC020Q	Extender (Silver)
A9	XVUC21B	DC body
	XVUC21BQ	DC body (Silver)
A10	XVUC21M	AC body NPN
	XVUC21MP	AC body PNP
	XVUC21MQP	AC body PNP (Silver)
A11	XVUZ06	Flexible option
A12	XVUZ01	Fixing Unit - Direct mounting (3 pins)
	XVUZ01Q	Fixing Unit - Direct mounting (Silver,3 pins)
	XVUZ03	Fixing Unit - Direct mounting (2 pins)
	XVUZ04	Fixing Unit - Direct mounting (4 pins)
A13	XVUZ02	Fixing Unit - Plate with Pole (100 mm)
	XVUZ02Q	Fixing Unit - Plate with Pole (100 mm, Silver)
	XVUZ400	Fixing Unit - Plate with Pole (400 mm)
	XVUZ800	Fixing Unit - Plate with Pole (800 mm)
A14	XVUZ05	Fixing Unit - Plate with adjustment pole (100-385 mm)
A15	XVUC43	Green LED unit, Flash
	XVUC44	Red LED unit, Flash
	XVUC45	Orange LED unit, Flash
	XVUC46	Blue LED unit, Flash

Drawing	Part number	Part name
	XVUC47	White LED unit, Flash
	XVUC48	Yellow LED unit, Flash
A16	XVUZ100T	Fixing Unit - Metal bracket with pole (100 mm)
	XVUZ250T	Fixing Unit - Metal bracket with pole(250 mm)
	XVUZ400T	Fixing Unit - Metal bracket with pole (400 mm)
A17	XVUZ12	Fixing plate for use on vertical support - black

Connections and Schema

Illuminated Units, Multi-LED and Audible Units Wiring

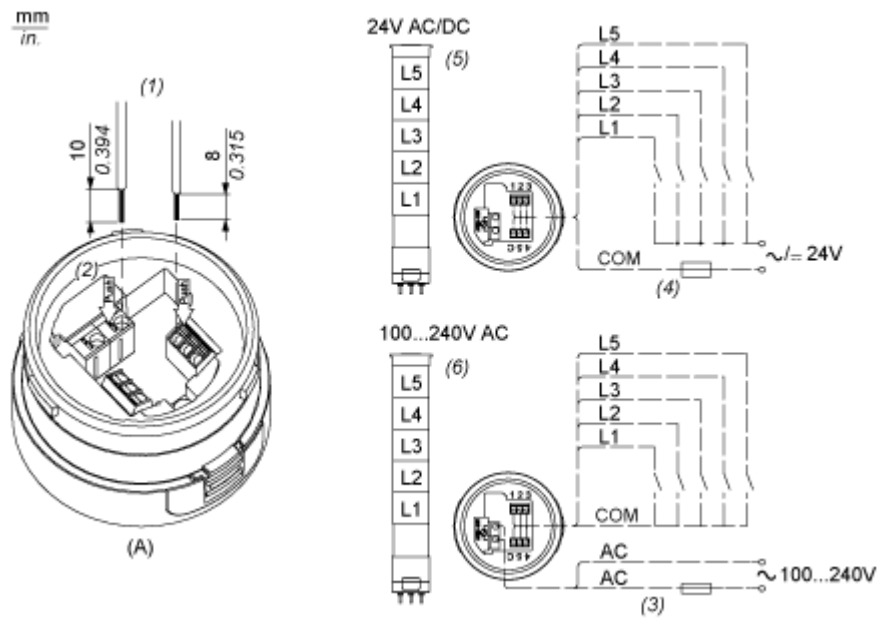

- (A) Fixing Unit
 - (1) Dimensions of Wiring size
 - (2) Push-in Wire Connectors
 - (3) Fuse : 2A ,250V
 - (4) Fuse : 0.5A ,125V
 - (5) Modular Tower Lights 24V AC/DC
 - (6) Modular Tower Lights 100...240V AC
- L1 to L5 : Illuminated LED Units

Technical Illustration

Dimensions

mm
in.

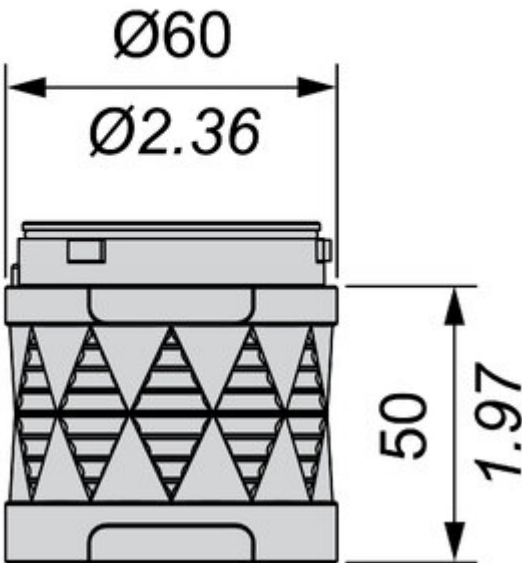

Technical Illustration

Wiring diagram

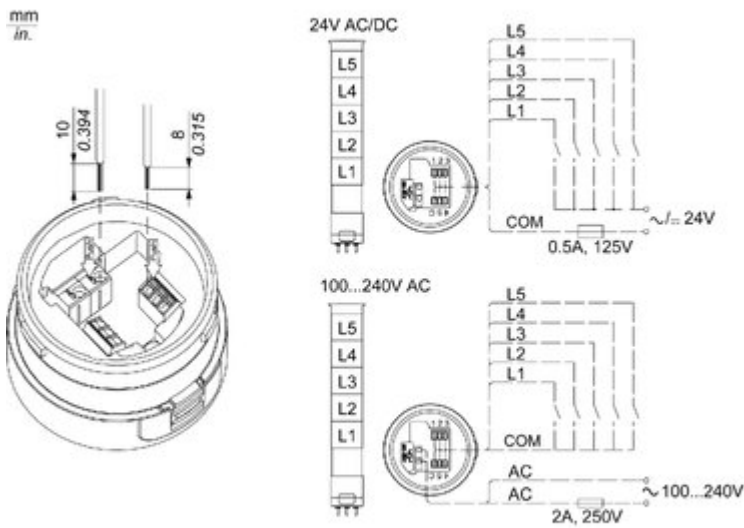

Offer Marketing Illustration

Product benefits / Features

Technical Benefits
Harmony XVU



Offer Marketing Illustration

Product benefits / Features

Features

Harmony XVU



6 colors + multi color LED with 4 light patterns: steady, flashing, blinking, and rotating



4 mounting styles: flexible, wall, pole, or direct mounting



Programmable sounders that is configurable via the SD card



Modular design supporting customization up to 5 light units



Simplified installation, easy maintenance, and direct connection to PLC

