

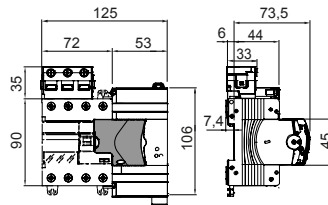

Description Automatic reclosing device
 Code ReStart Rm PRO 4P
 Suitable for RCBO's MDC - 1P+N/2P/4P - 100 and 300 mA
 Rated voltage AC 230 V
 Rated current 6 - 10 - 16 - 20 -25 - 32 A
 No. modules 3
 Standard EN 50557
 Rated frequency (Hz) 50Hz

Distribution system	TT - TN-S	Rated non-operating resistance between live parts and earth (Rdo)	2,5 kΩ
Insulation voltage	500 V	Rated operating resistance between live parts and earth (Rd)	5 kΩ
Rated impulse withstand voltage	4 kV	Maximum operating frequency	30 oper./h
Overvoltage category	III	Mechanical endurance	4000
Dielectric strength test voltage between pole and earth	2500 Vac for 1 minute	Type of residual current protection	AC - A - A[S]
Rated residual operating current	300 mA	Operating temperature	-25 +60 °C
Stocking temperature	-40 +70 °C	Type of contacts	Photomos (potential free)
Voltage operating	5-230 V ac/dc	Current operating	0.6mA (min)-100mA cos= 1 (max)
Operating frequency	50 Hz	Use category	AC12
Operating modes	NO/NC/NO with handle position signalling function	Rated tightening torque	0,4 Nm
Terminal section	≤ 2,5 mm²	Automatic reclosure for untimely tripping	Yes
Earth failure test	Yes	Continuous system monitoring	Yes
Complete with	One device among: GW90945 Wi-Fi Module - GWD0951 Auxiliary contact - GW90992 RS485 BUS Module	Electrocod	1413
Compatibility with WiFi interface	Yes		

DIMENSIONAL



STANDARDS/APPROVALS

