

SE E18 (785 650)

- For indoor installations
- Protection against reconnection
- With "Nicht schalten" symbol [Do not close the circuit] acc. to national regulations (VBG 125)
- Insulating plug for screw inserts



Figure without obligation

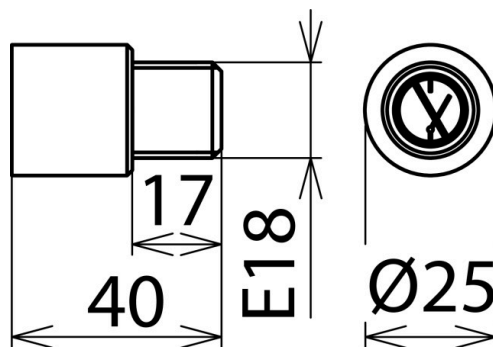

Figure without obligation

Type	SE E18
Part No.	785 650
Nominal voltage (U _N)	Up to 1000 V
Size	E18
Diameter	25 mm
Dimensions	Ø25 x 40 mm
Standard	VBG 125 and DIN 40008
Use	For indoor installations
Weight	22 g
Customs tariff number (Comb. Nomenclature EU)	39269097
GTIN	4013364106536
PU	10 pc(s)

We reserve the right to introduce changes in performance, configuration and technology, dimensions, weights and materials in the course of technical progress. The figures are shown without obligation.