

CONCORD BEACON MUSE 3000K O/B DIM BLACK

Artikelnummer 2062563

Concord

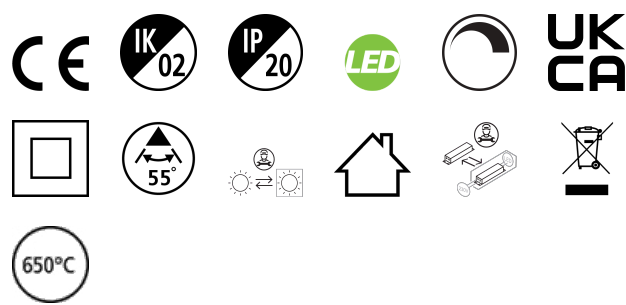

Simple and slick integral design with no driver box and without any visible screws New technology utilization for improved performance Invisible in-track adaptor for an impressive architectural look Extremely precise light beams due to the high-quality lens ø80mm die-cast aluminium body, Adjustable beam angle: between 8° - 55°, Textured black finishing colour Light color temperature: 3000K, warm light System power: 18W, Fixture lumen output: 980lm, efficacy: 55lm/W, Ra97 typical, LED chromacity: 2 step MacAdam ellipse LED source (SDCM2), IR/UV free light source without heat radiation Operating voltage 220-240V / 50-60Hz, dimmable via on-board potentiometer, suitable for installation on 3-circuit tracks, please check compatibility list on the instruction sheet. Compatible with OneTrack Electrical protection: Class II. Degree of protection: IP20, suitable for indoor environment only Horizontal rotation: 355°, vertical tilt: 90° Nominal product dimensions: D.80mmx215mm 5 years warranty. Suitable for track mounting

Technische activa

Afmetingen (mm)

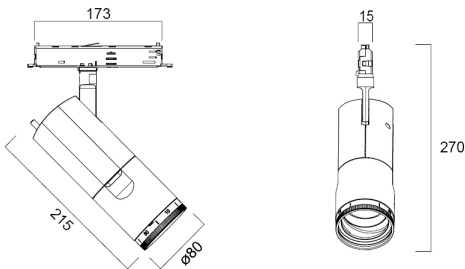

Fotometrie

Distance [m]	Cone diameter [m]	Beam angle [°]	Beam diameter [m]	Beam area [m²]	Beam area [ft²]
0.5	0.08	8°	0.08	0.005	0.05
1.0	0.16	16°	0.16	0.02	0.2
1.5	0.24	24°	0.24	0.04	0.4
2.0	0.31	31°	0.31	0.06	0.6
2.5	0.38	38°	0.38	0.09	0.9
3.0	0.45	45°	0.45	0.12	1.2
3.5	0.52	52°	0.52	0.16	1.6
4.0	0.59	59°	0.59	0.21	2.1
4.5	0.66	66°	0.66	0.27	2.7
5.0	0.73	73°	0.73	0.34	3.4
5.5	0.80	80°	0.80	0.41	4.1
6.0	0.87	87°	0.87	0.49	4.9
6.5	0.94	94°	0.94	0.57	5.7
7.0	1.01	101°	1.01	0.66	6.6
7.5	1.08	108°	1.08	0.75	7.5
8.0	1.15	115°	1.15	0.85	8.5
8.5	1.22	122°	1.22	0.96	9.6
9.0	1.29	129°	1.29	1.07	10.7
9.5	1.36	136°	1.36	1.19	11.9
10.0	1.43	143°	1.43	1.31	13.1
10.5	1.50	150°	1.50	1.44	14.4
11.0	1.57	157°	1.57	1.57	15.7
11.5	1.64	164°	1.64	1.71	17.1
12.0	1.71	171°	1.71	1.85	18.5
12.5	1.78	178°	1.78	2.00	20.0
13.0	1.85	185°	1.85	2.15	21.5
13.5	1.92	192°	1.92	2.31	23.1
14.0	1.99	199°	1.99	2.47	24.7
14.5	2.06	206°	2.06	2.64	26.4
15.0	2.13	213°	2.13	2.81	28.1
15.5	2.20	220°	2.20	2.99	29.9
16.0	2.27	227°	2.27	3.17	31.7
16.5	2.34	234°	2.34	3.36	33.6
17.0	2.41	241°	2.41	3.55	35.5
17.5	2.48	248°	2.48	3.75	37.5
18.0	2.55	255°	2.55	3.95	39.5
18.5	2.62	262°	2.62	4.16	41.6
19.0	2.69	269°	2.69	4.37	43.7
19.5	2.76	276°	2.76	4.59	45.9
20.0	2.83	283°	2.83	4.81	48.1
20.5	2.90	290°	2.90	5.03	50.3
21.0	2.97	297°	2.97	5.26	52.6
21.5	3.04	304°	3.04	5.49	54.9
22.0	3.11	311°	3.11	5.72	57.2
22.5	3.18	318°	3.18	5.96	59.6
23.0	3.25	325°	3.25	6.20	62.0
23.5	3.32	332°	3.32	6.45	64.5
24.0	3.39	339°	3.39	6.70	67.0
24.5	3.46	346°	3.46	6.96	69.6
25.0	3.53	353°	3.53	7.22	72.2
25.5	3.60	360°	3.60	7.49	74.9
26.0	3.67	367°	3.67	7.76	77.6
26.5	3.74	374°	3.74	8.03	80.3
27.0	3.81	381°	3.81	8.31	83.1
27.5	3.88	388°	3.88	8.59	85.9
28.0	3.95	395°	3.95	8.88	88.8
28.5	4.02	402°	4.02	9.17	91.7
29.0	4.09	409°	4.09	9.47	94.7
29.5	4.16	416°	4.16	9.77	97.7
30.0	4.23	423°	4.23	10.08	100.8
30.5	4.30	430°	4.30	10.39	103.9
31.0	4.37	437°	4.37	10.70	107.0
31.5	4.44	444°	4.44	11.02	110.2
32.0	4.51	451°	4.51	11.34	113.4
32.5	4.58	458°	4.58	11.67	116.7
33.0	4.65	465°	4.65	12.00	120.0
33.5	4.72	472°	4.72	12.33	123.3
34.0	4.79	479°	4.79	12.67	126.7
34.5	4.86	486°	4.86	13.01	130.1
35.0	4.93	493°	4.93	13.36	133.6
35.5	5.00	500°	5.00	13.71	137.1
36.0	5.07	507°	5.07	14.06	140.6
36.5	5.14	514°	5.14	14.42	144.2
37.0	5.21	521°	5.21	14.78	147.8
37.5	5.28	528°	5.28	15.14	151.4
38.0	5.35	535°	5.35	15.51	155.1
38.5	5.42	542°	5.42	15.88	158.8
39.0	5.49	549°	5.49	16.25	162.5
39.5	5.56	556°	5.56	16.63	166.3
40.0	5.63	563°	5.63	17.01	170.1
40.5	5.70	570°	5.70	17.39	173.9
41.0	5.77	577°	5.77	17.78	177.8
41.5	5.84	584°	5.84	18.17	181.7
42.0	5.91	591°	5.91	18.57	185.7
42.5	5.98	598°	5.98	18.97	189.7
43.0	6.05	605°	6.05	19.38	193.8
43.5	6.12	612°	6.12	19.79	197.9
44.0	6.19	619°	6.19	20.20	202.0
44.5	6.26	626°	6.26	20.61	206.1
45.0	6.33	633°	6.33	21.03	210.3
45.5	6.40	640°	6.40	21.45	214.5
46.0	6.47	647°	6.47	21.87	218.7
46.5	6.54	654°	6.54	22.30	223.0
47.0	6.61	661°	6.61	22.72	227.2
47.5	6.68	668°	6.68	23.15	231.5
48.0	6.75	675°	6.75	23.58	235.8
48.5	6.82	682°	6.82	24.01	240.1
49.0	6.89	689°	6.89	24.44	244.4
49.5	6.96	696°	6.96	24.88	248.8
50.0	7.03	703°	7.03	25.31	253.1
50.5	7.10	710°	7.10	25.75	257.5
51.0	7.17	717°	7.17	26.19	261.9
51.5	7.24	724°	7.24	26.63	266.3
52.0	7.31	731°	7.31	27.07	270.7
52.5	7.38	738°	7.38	27.52	275.2
53.0	7.45	745°	7.45	27.96	279.6
53.5	7.52	752°	7.52	28.41	284.1
54.0	7.59	759°	7.59	28.86	288.6
54.5	7.66	766°	7.66	29.31	293.1
55.0	7.73	773°	7.73	29.76	297.6
55.5	7.80	780°	7.80	30.21	302.1
56.0	7.87	787°	7.87	30.66	306.6
56.5	7.94	794°	7.94	31.12	311.2
57.0	8.01	801°	8.01	31.57	315.7
57.5	8.08	808°	8.08	32.03	320.3
58.0	8.15	815°	8.15	32.48	324.8
58.5	8.22	822°	8.22	32.94	329.4
59.0	8.29	829°	8.29	33.39	333.9
59.5	8.36	836°	8.36	33.85	338.5
60.0	8.43	843°	8.43	34.30	343.0
60.5	8.50	850°	8.50	34.76	347.6
61.0	8.57	857°	8.57	35.21	352.1
61.5	8.64	864°	8.64	35.67	356.7
62.0	8.71	871°	8.71	36.12	361.2
62.5	8.78	878°	8.78	36.58	365.8
63.0	8.85	885°	8.85	37.03	370.3
63.5	8.92	892°	8.92	37.49	374.9
64.0	8.99	899°	8.99	37.94	379.4
64.5	9.06	906°	9.06	38.40	384.0
65.0	9.13	913°	9.13	38.85	388.5
65.5	9.20	920°	9.20	39.31	393.1
66.0	9.27	927°	9.27	39.76	397.6
66.5	9.34	934°	9.34	40.22	402.2
67.0	9.41	941°	9.41	40.67	406.7
67.5	9.48	948°	9.48	41.13	411.3
68.0	9.55	955°	9.55	41.58	415.8
68.5	9.62	962°	9.62	42.04	420.4
69.0	9.69	969°	9.69	42.49	424.9
69.5	9.76	976°	9.76	42.95	429.5
70.0	9.83	983°	9.83	43.40	434.0
70.5	9.90	990°	9.90	43.86	438.6
71.0	9.97	997°	9.97	44.31	443.1
71.5	10.04	1004°	10.04	44.76	447.6
72.0	10.11	1011°	10.11	45.22	452.2
72.5	10.18	1018°	10.18	45.67	456.7
73.0	10.25	1025°	10.25	46.12	461.2
73.5	10.32	1032°	10.32	46.58	465.8
74.0	10.39	1039°	10.39	47.03	470.3
74.5	10.46	1046°	10.46	47.48	474.8
75.0	10.53	1053°	10.53	47.94	479.4
75.5	10.60	1060°	10.60	48.39	483.9
76.0	10.67	1067°	10.67	48.85	488.5
76.5	10.74	1074°	10.74	49.30	493.0
77.0	10.81	1081°	10.81	49.76	497.6
77.5	10.88	1088°	10.88	50.21	502.1
78.0	10.95	1095°	10.95	50.67	506.7
78.5	11.02	1102°	11.02	51.12	511.2
79.0	11.09	1109°	11.09	51.58	515.8
79.5	11.16	1116°	11.16	52.03	520.3
80.0	11.23	1123°	11.23	52.48	524.8
80.5	11.30	1130°	11.30	52.94	529.4
81.0	11.37	1137°	11.37	53.39	533.9
81.5	11.44	1144°	11.44	53.85	538.5
82.0	11.51	1151°	11.51	54.30	543.0
82.5	11.58	1158°	11.58	54.76	547.6
83.0	11.65	1165°	11.65	55.21	552.1
83.5	11.72	1172°	11.72	55.67	556.7
84.0	11.79	1179°	11.79	56.12	561.2
84.5	11.86	1186°	11.86	56.58	565.8
85.0	11.93	1193°	11.93	57.03	570.3
85.5	12.00	1200°	12.00	57.48	574.8
86.0	12.07	1207°	12.07	57.94	579.4
86.5	12.14	1214°	12.14	58.39	583.9
87.0	12.21	1221°	12.21	58.85	588.5
87.5	12.28	1228°	12.28	59.30	593.0
88.0	12.35	1235°	12.35	59.76	597.6
88.5	12.42	1242°	12.42	60.21	602.1
89.0	12.49	1249°	12.49	60.67	606.7
89.5	12.56	1256°	12.56	61.12	611.2
90.0	12.63	1263°	12.63	61.58	615.8
90.5	12.70	1270°	12.70	62.03	620.3
91.0	12.77	1277°	12.77	62.48	624.8
91.5	12.84	1284°	12.84	62.94	629.4
92.0	12.91	1291°	12.91	63.39	633.9
92.5	12.98	1298°	12.98	63.85	638.5
93.0	13.05	1305°	13.05	64.30	643.0
93.5	13.12	1312°	13.12	64.76	647.6
94.0	13.19	1319°	13.19	65.21	652.1
94.5	13.26	1326°	13.26	65.67	656.7
95.0	13.33	1333°	13.33	66.12	661.2
95.5	13.40	1340°	13.40	66.58	66

CONCORD BEACON MUSE 3000K O/B DIM BLACK

Artikelnummer 2062563

Concord

General data

Productnaam	CONCORD BEACON MUSE 3000K O/B DIM BLACK
Technologie	LED
Lampvoet	N/A
Behuizing	Aluminium
Montage	Railmontage
Type armatuur (open/gesloten)	Ingesloten
Algemene toepassing	Musea & Galeries, Retail, Horeca
Omgevingstemperatuur (°C)	-10°C...+35°C
ETIM klasse	EC001744
E-nummer FI	4170389
Garantie	5 jaar

Optical data

Lichtstroom	1000
Lumenstroom armatuur (lm)	980
Efficiëntie armatuur lm/W	55
LOR (%)	100
Kleurtemperatuur (K)	3000
Lichtkleur	Warmwit
CRI (Ra)	97
Initiële kleurvariatie (SDCM)	SDCM2
Luminous Intensity (cd)	980
Bundel breedte (°)	55
Type licht distributie	Symmetric
Photobiological Risk Group	RG1

Electrical data

Totaal energieverbruik (W)	18
Stroom (A)	0.082
Primaire voedingsspanning min	220.0
Primaire voedingsspanning max	240.0
Lamp arbeidsfactor	0.9
THD (bij 230 V, 50 Hz, volledige belasting, bij 100% dimniveau) ≤ xx.x %	7.9
Elektrische beschermingsklasse	Klasse II
Type ballast	LED constante stroom driver
Dimbaar	Yes
Dimtechnologie	Onboard pot
Minimum dimniveau (%)	1
Stuurstroom driver (mA)	500
Inschakelstroom (A)	5
Duur inschakelstroom (µs)	50
Energie-efficiëntieklasse (A->G) van de lichtbron in dit product	F
Nominale frequentie (Hz)	50/60Hz
Max. Armaturen per 10A C automaat	31
Max. Armaturen per 13A C automaat	65
Max. Armaturen per 16A C automaat	85
Max. Armaturen per 20A C automaat	104
Max. Armaturen per 10A B automaat	31
Max. Armaturen per 13A B automaat	39
Max. Armaturen per 16A B automaat	50
Max. Armaturen per 20A B automaat	62

Lifetime data

Gemiddelde nominale levensduur - L70 B50	100000
Gemiddelde nominale levensduur - L80 B50	100000
Gemiddelde nominale levensduur - L90 B50	49000

CONCORD BEACON MUSE 3000K O/B DIM BLACK

Artikelnummer 2062563

Concord

Physical data

Kleur behuizing	RAL 9005 - Jet black
IP waarde	IP20
IK waarde	IK02
Afwerking diffusor	Gezandstraald
Materiaal diffusor	Overige
Afwerking reflector	Mat
Lengte (mm)	215
Breedte (mm)	80
Hoogte (mm)	270
Nominale diameter product (mm)	80
Gewicht (kg)	0.94

Packaging

EAN code	5025768625635
Enkele lengte verpakking (cm)	30.5
Enkele breedte verpakking (cm)	13.5
Hoogte eenheidsverpakking (cm)	20.5
DUN14 (inner)	05025768625635
Eenheden per omdoos	1
Lengte omdoos (cm)	30.5
Breedte omdoos (cm)	13.5
Diepte omdoos (cm)	20.5

Safety data

Gloeidraad test (°)	650
Optimale bedrijfsomstandigheden (°C)	-10-35
Uitsluitend te gebruiken in droge toepassingen	Ja